

City of Toronto Zoning By-law 569-2013

The new City-wide Zoning By-law 569-2013 was enacted on May 9, 2013. It has been appealed under section 34(19) of the Planning Act. Even though it is under appeal, the City's Chief Building Official and the Committee of Adjustment will apply the new By-law to applications filed after its enactment. Please consult with your advisors to determine whether the new by-law has any impact.

Amendments to By-law 569-2013 have been incorporated into this [office consolidation](#). The original by-law and its amendments are with the City Clerk's office.

[Contact Us](#)[Print](#)

950 king street west

Zoning Map

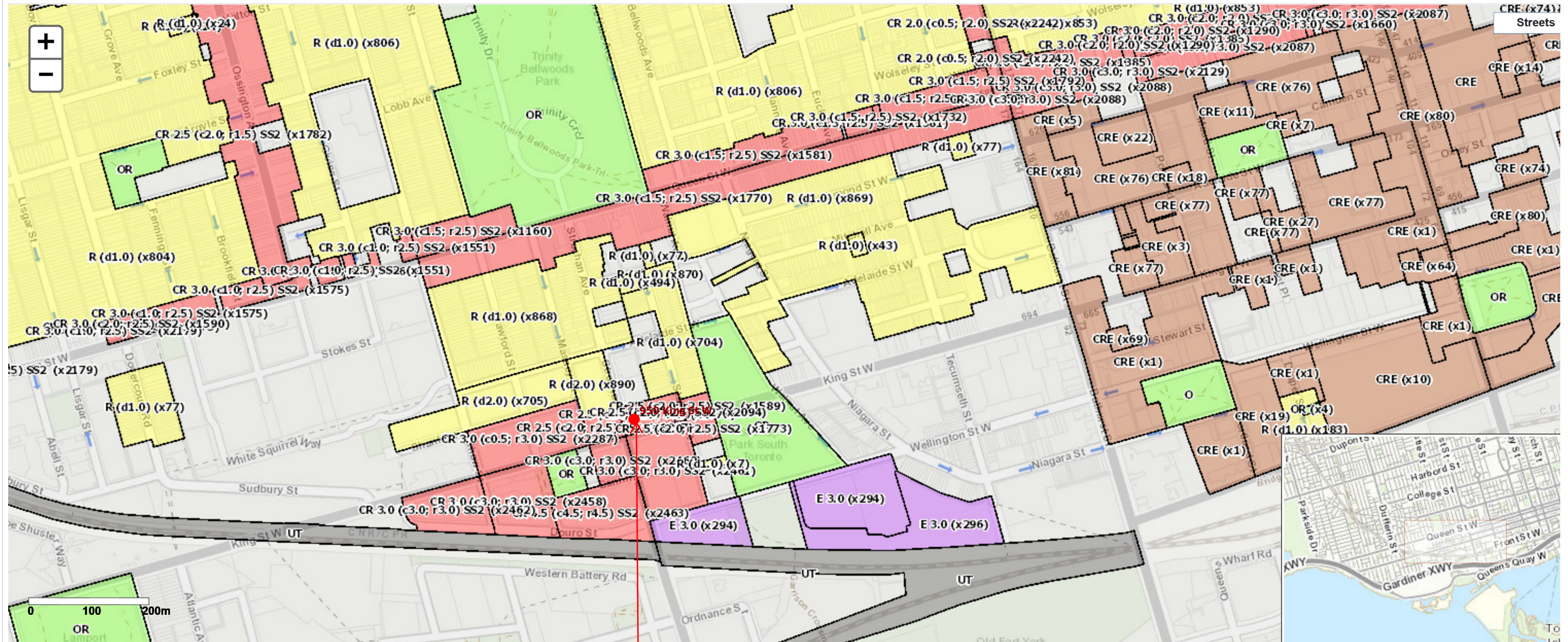
**TORONTO ZONING MAP****SUBJECT SITE**

NOTE: ALL SETBACKS, HEIGHTS AND FLOOR PLATE AREAS FOR POTENTIAL DEVELOPMENTS IN THIS DOCUMENT MATCH THOSE OF THE CURRENT PROPOSED DEVELOPMENT ON THE SUBJECT SITE LOCATED AT 950 KING STREET WEST

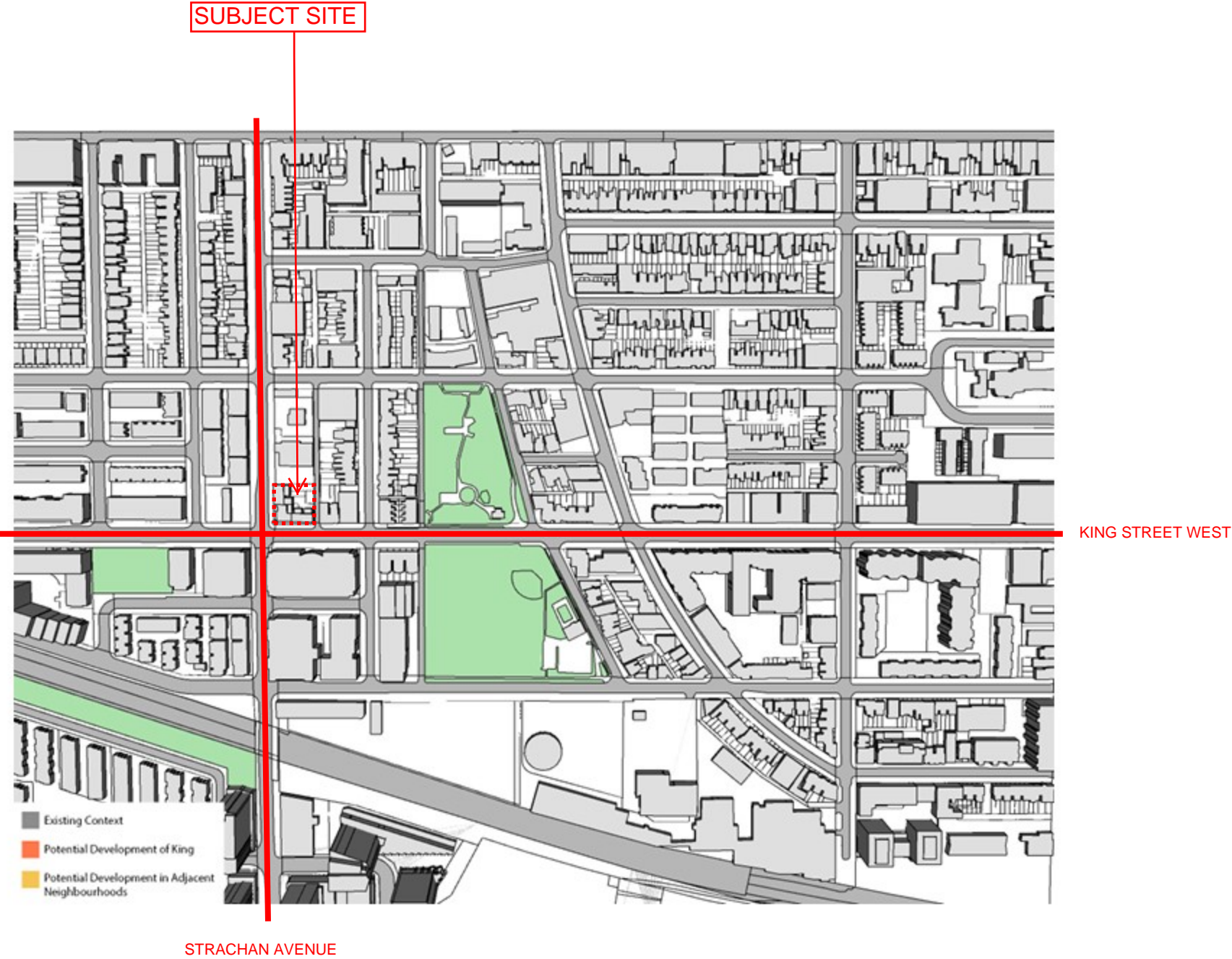

EXISTING CONTEXT PLAN

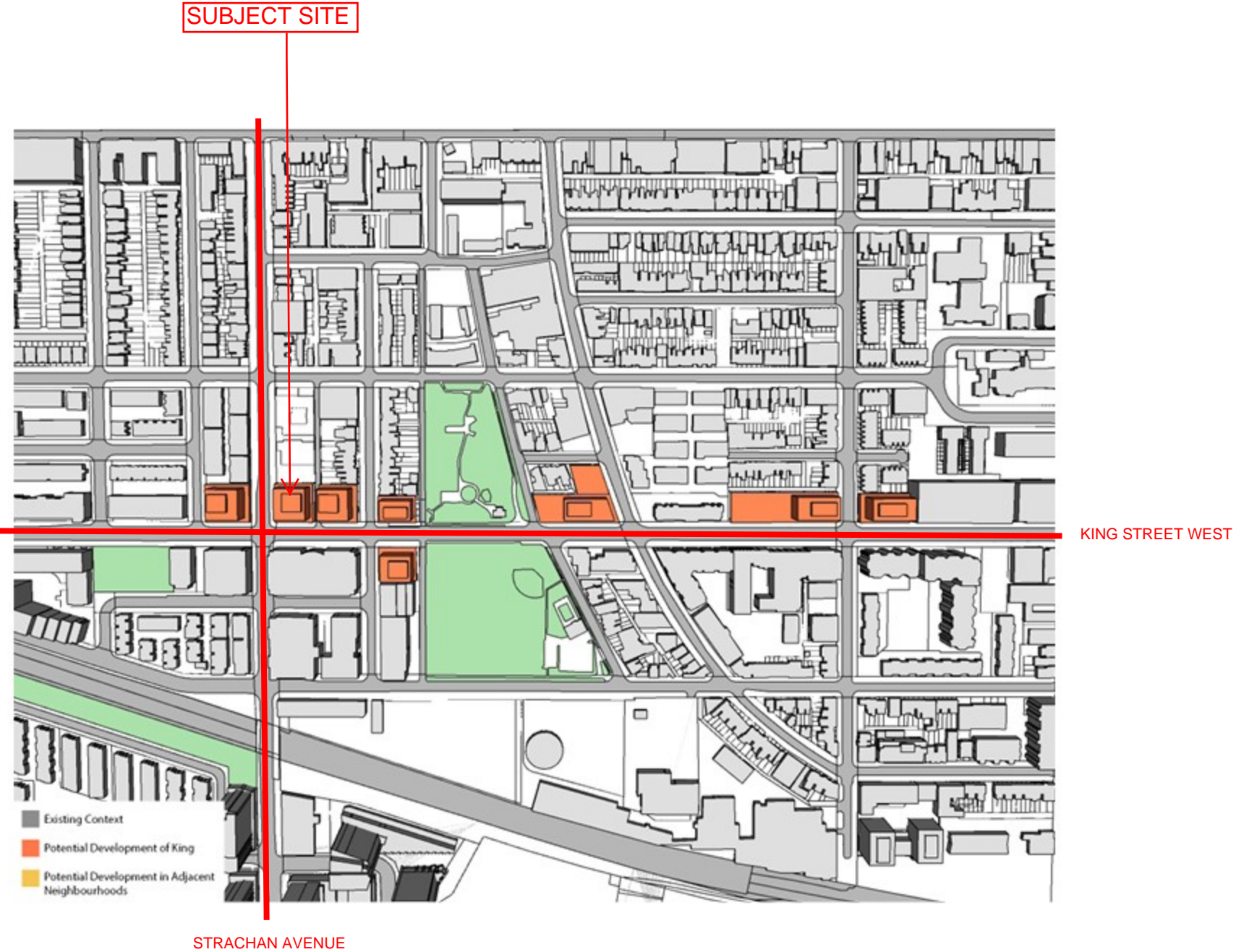

POTENTIAL DEVELOPMENT ON KING STREET WEST

SUBJECT SITE

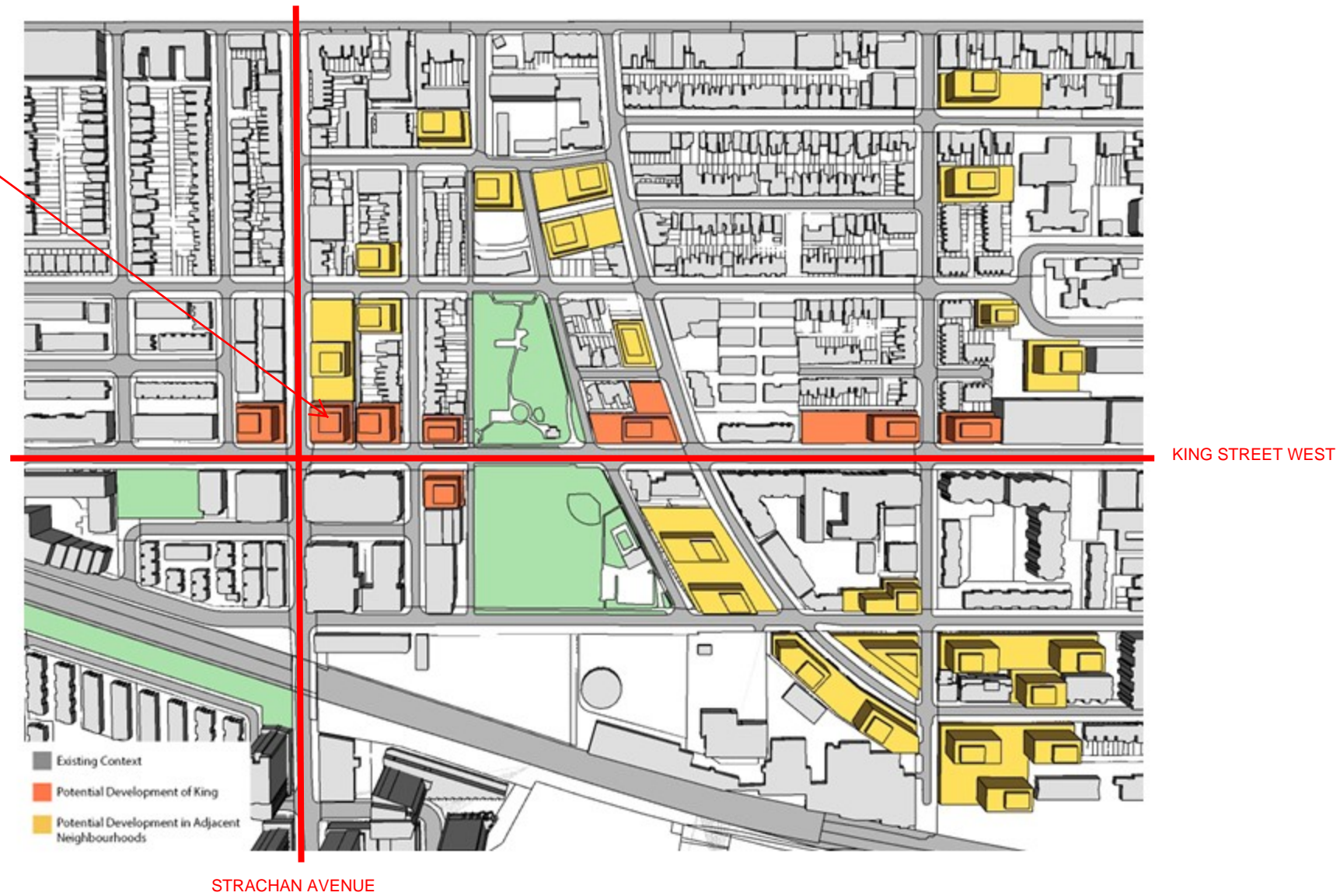

POTENTIAL DEVELOPMENT ON KING STREET WEST AND IN ADJACENT NEIGHBOURHOODS

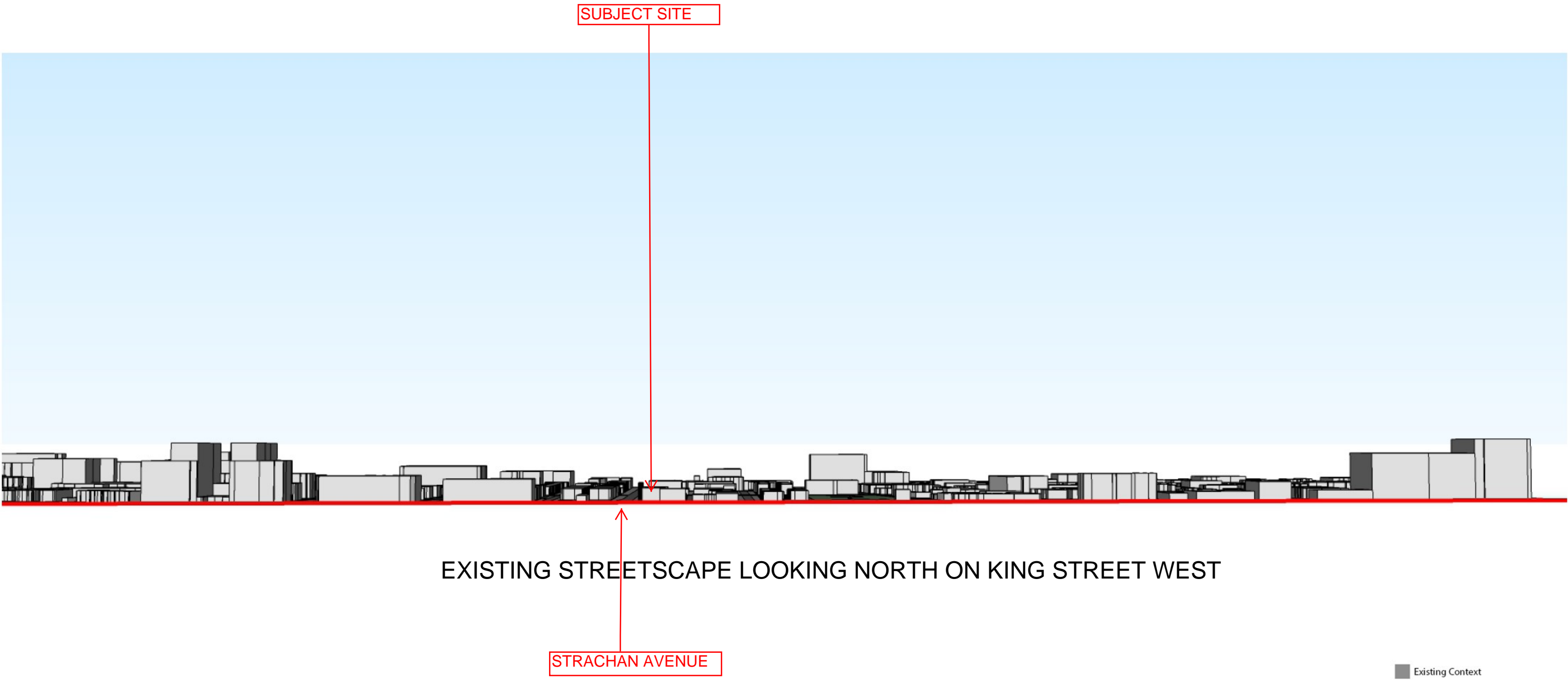

- Existing Context
- Potential Development of King
- Potential Development in Adjacent Neighbourhoods

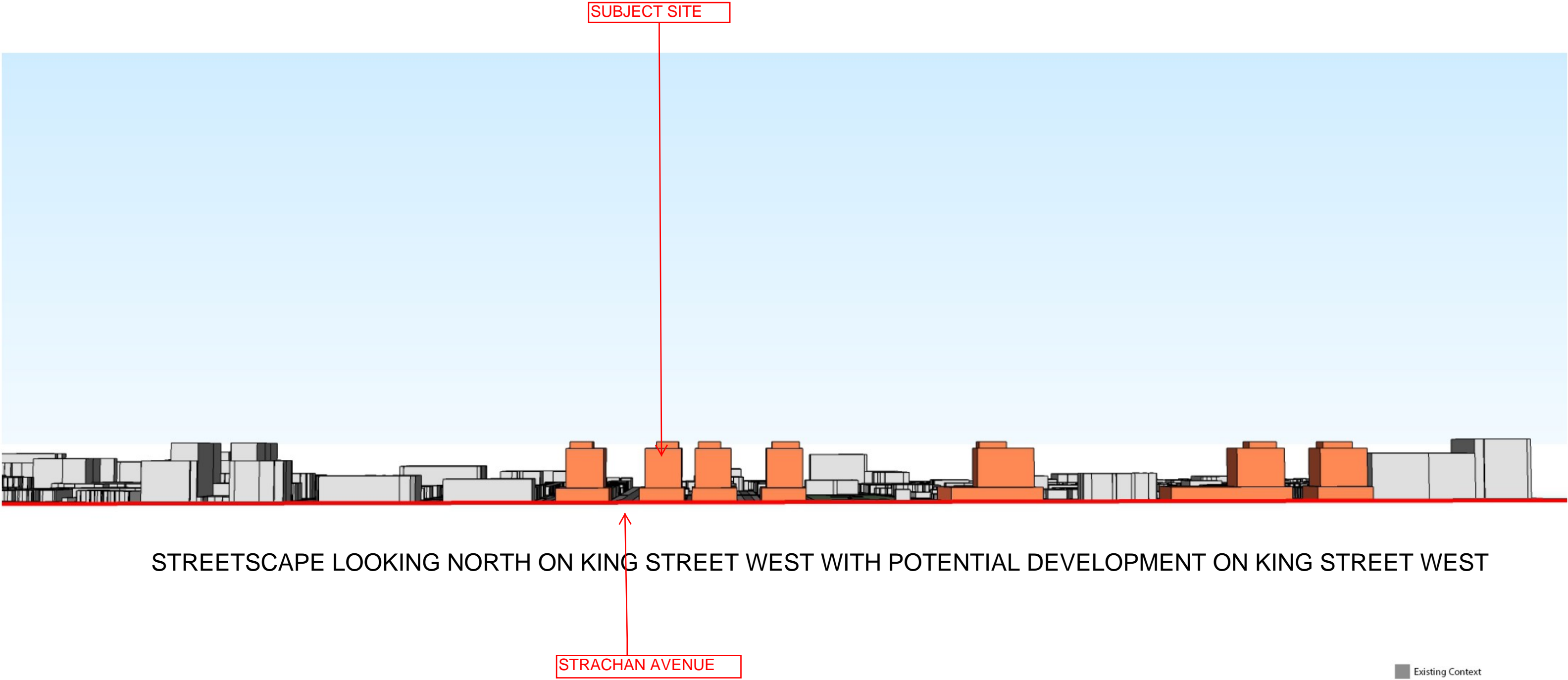

STREETSCAPE LOOKING NORTH ON KING STREET WEST WITH POTENTIAL DEVELOPMENT ON KING STREET WEST

- Existing Context
- Potential Development of King
- Potential Development in Adjacent Neighbourhoods

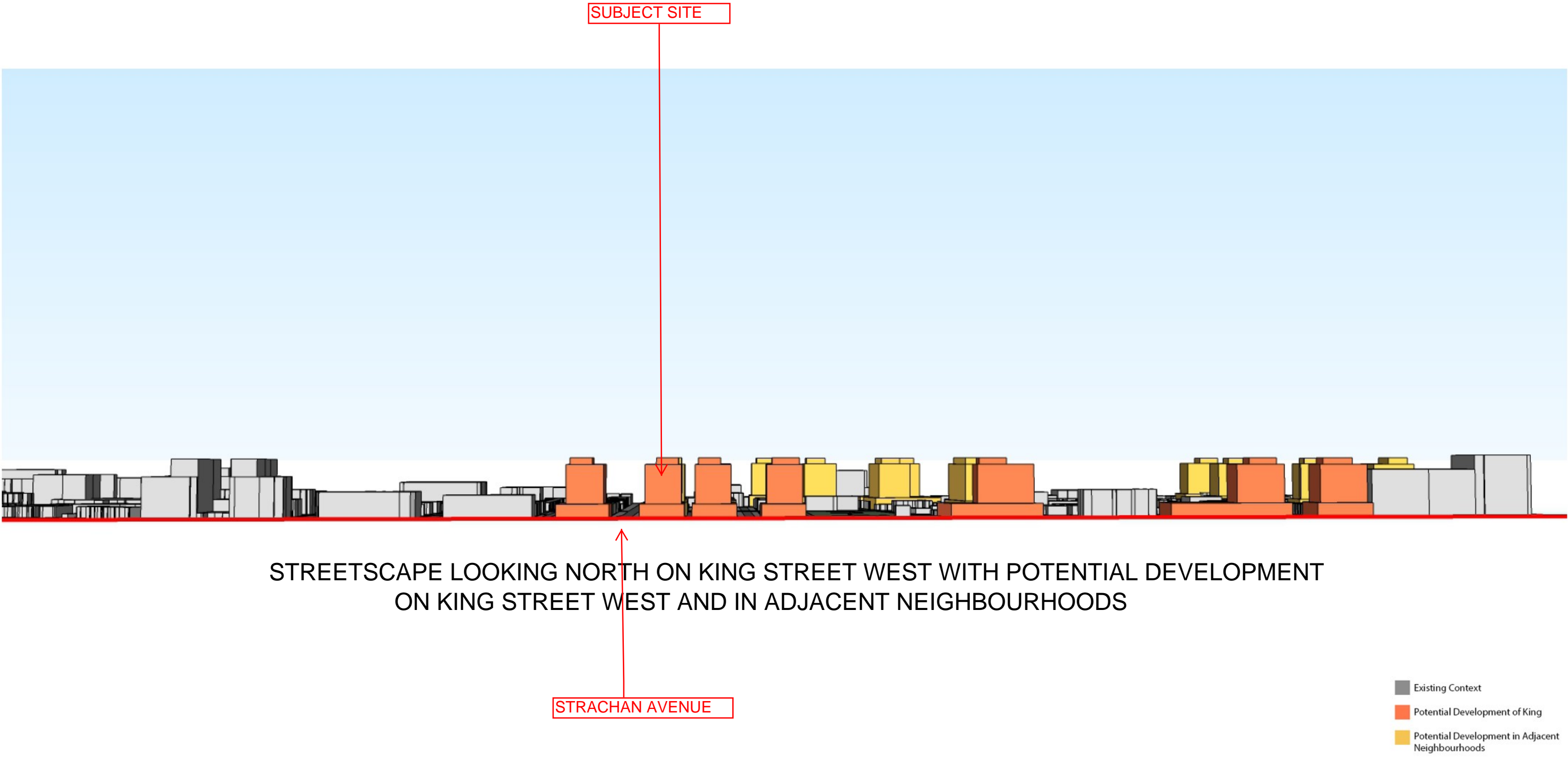

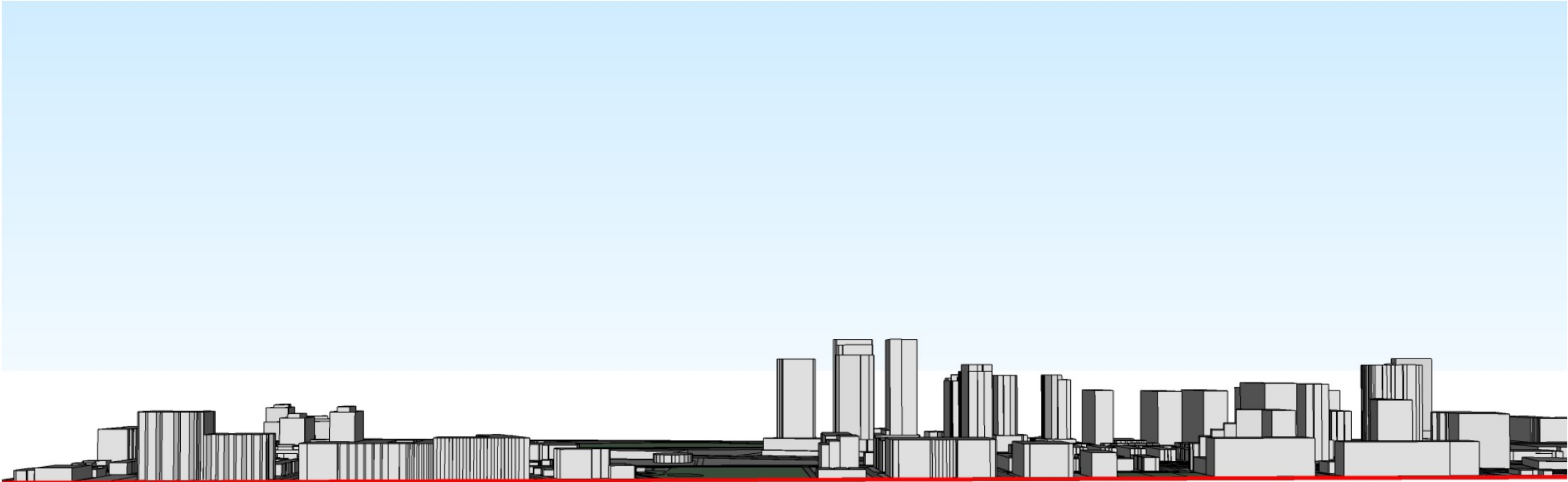

EXISTING STREETSCAPE LOOKING SOUTH ON KING STREET WEST



- Existing Context
- Potential Development of King
- Potential Development in Adjacent Neighbourhoods

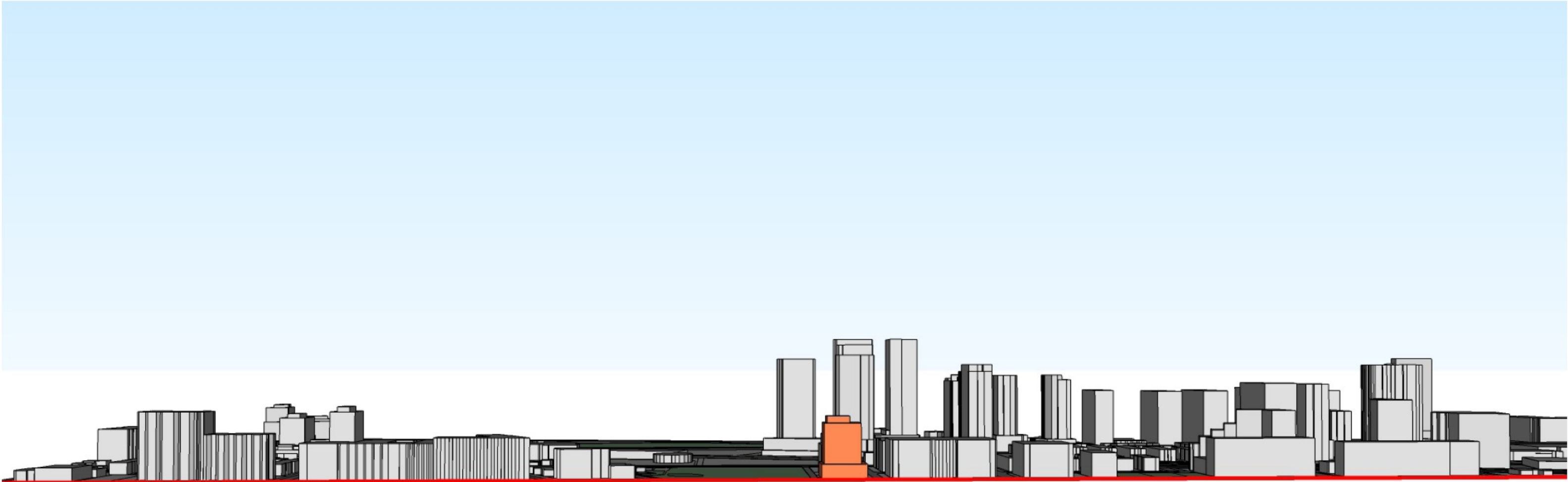

STREETSCAPE LOOKING SOUTH ON KING STREET WEST WITH POTENTIAL DEVELOPMENT ON KING STREET WEST

STRACHAN AVENUE

- Existing Context
- Potential Development of King
- Potential Development in Adjacent Neighbourhoods

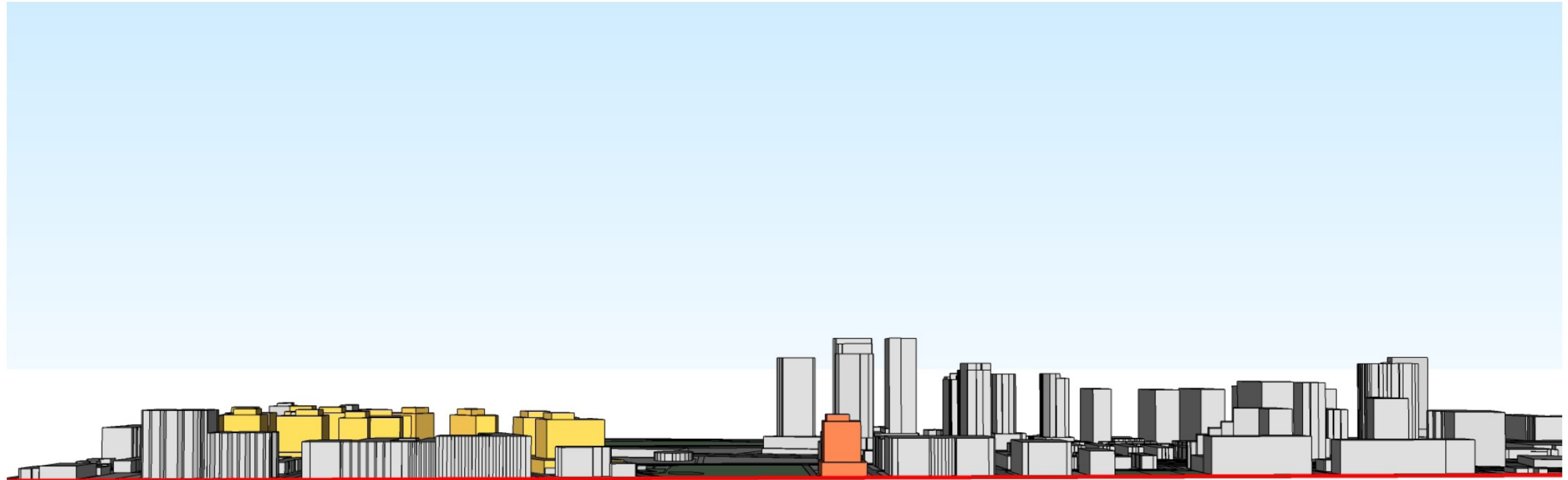

STREETSCAPE LOOKING SOUTH ON KING STREET WEST WITH POTENTIAL DEVELOPMENT
ON KING STREET WEST AND IN ADJACENT NEIGHBOURHOODS

STRACHAN AVENUE

- Existing Context
- Potential Development of King
- Potential Development in Adjacent Neighbourhoods

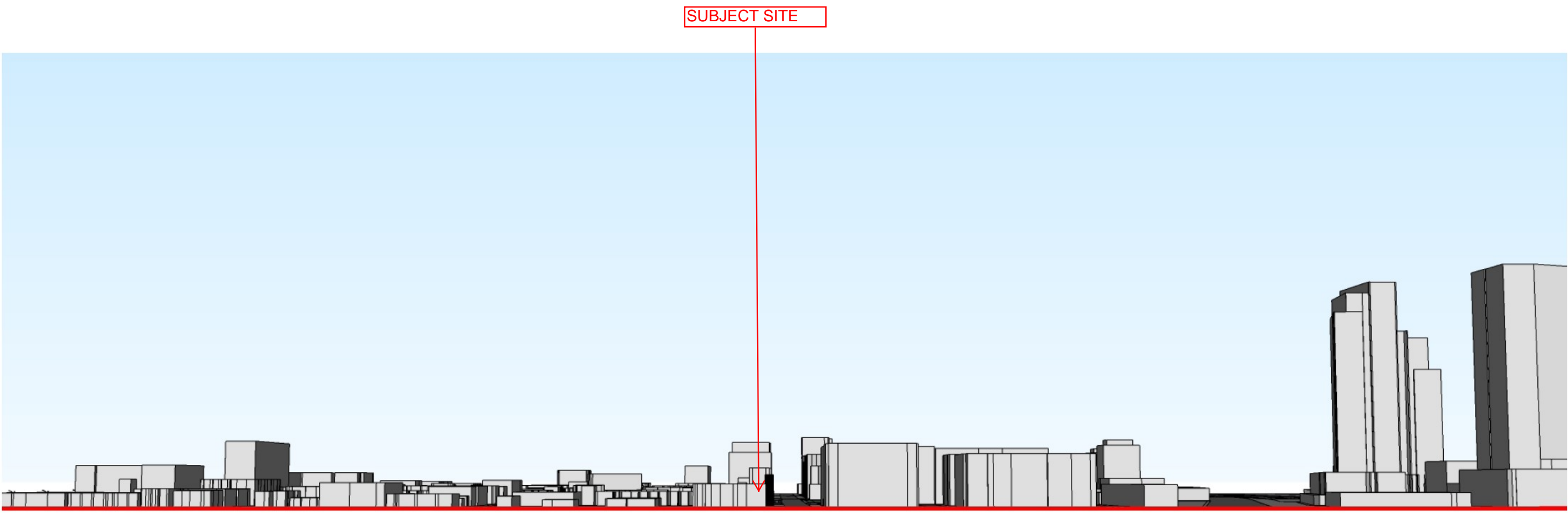

SUBJECT SITE

EXISTING STREETScape LOOKING EAST ON STRACHAN AVENUE

KING STREET WEST

- Existing Context
- Potential Development of King
- Potential Development in Adjacent Neighbourhoods

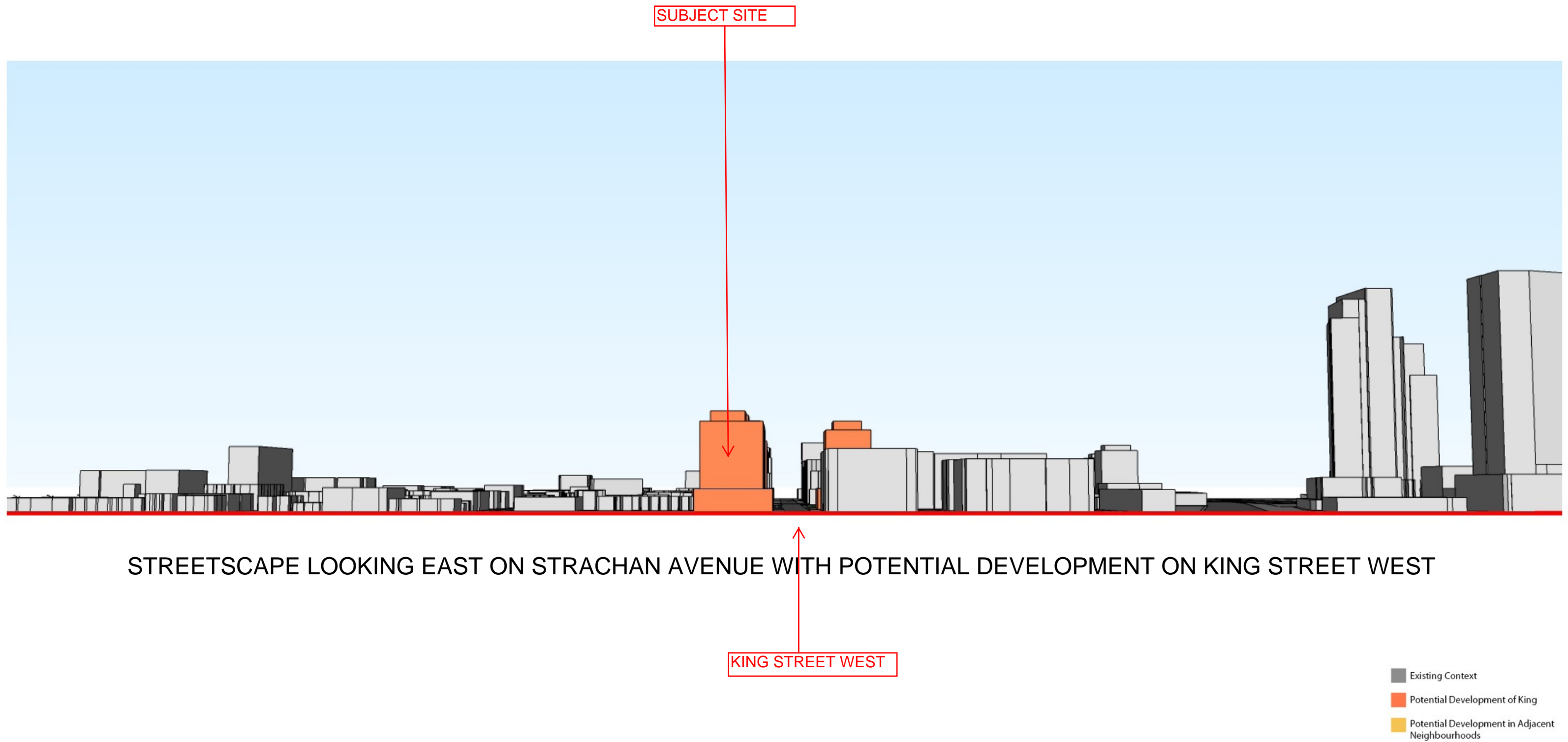

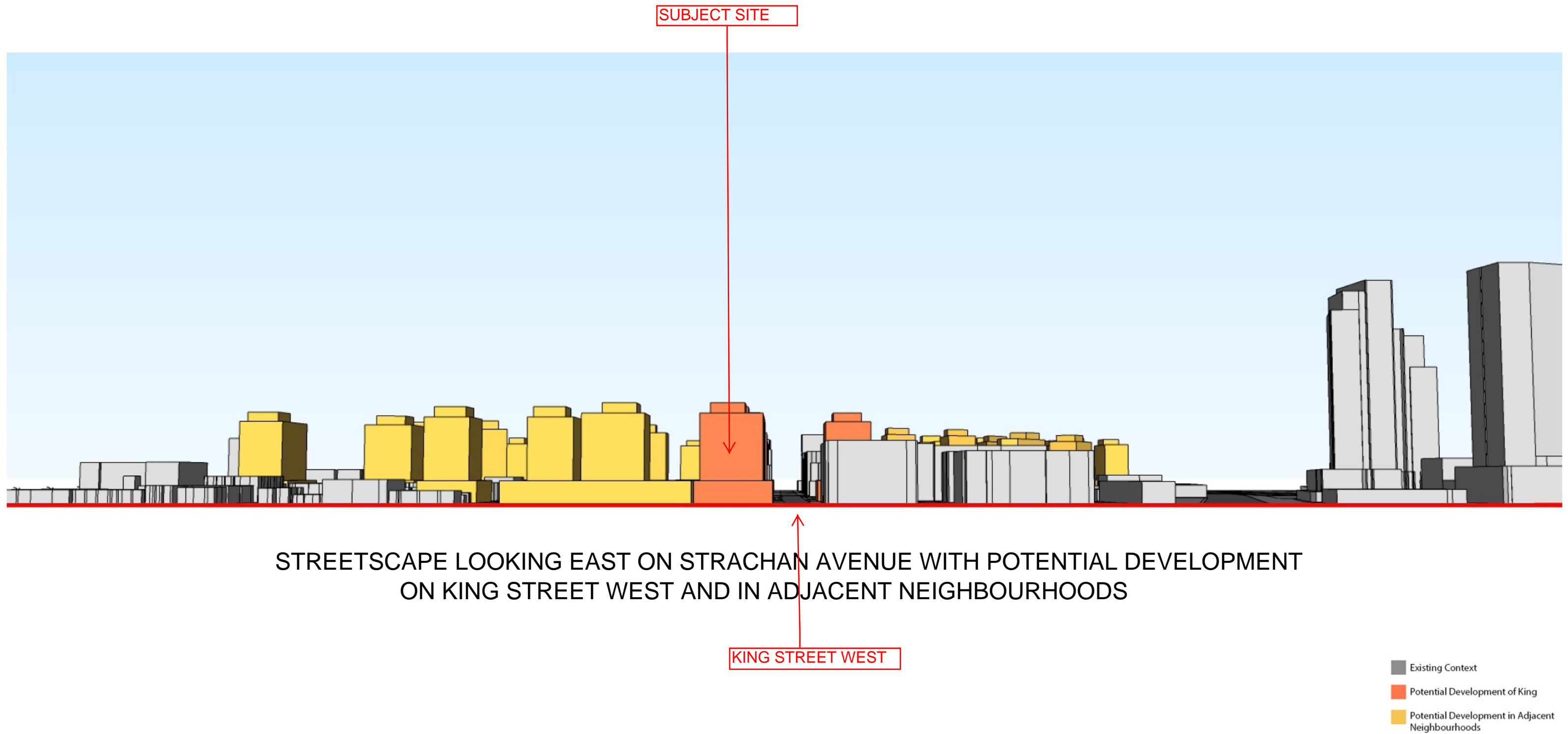

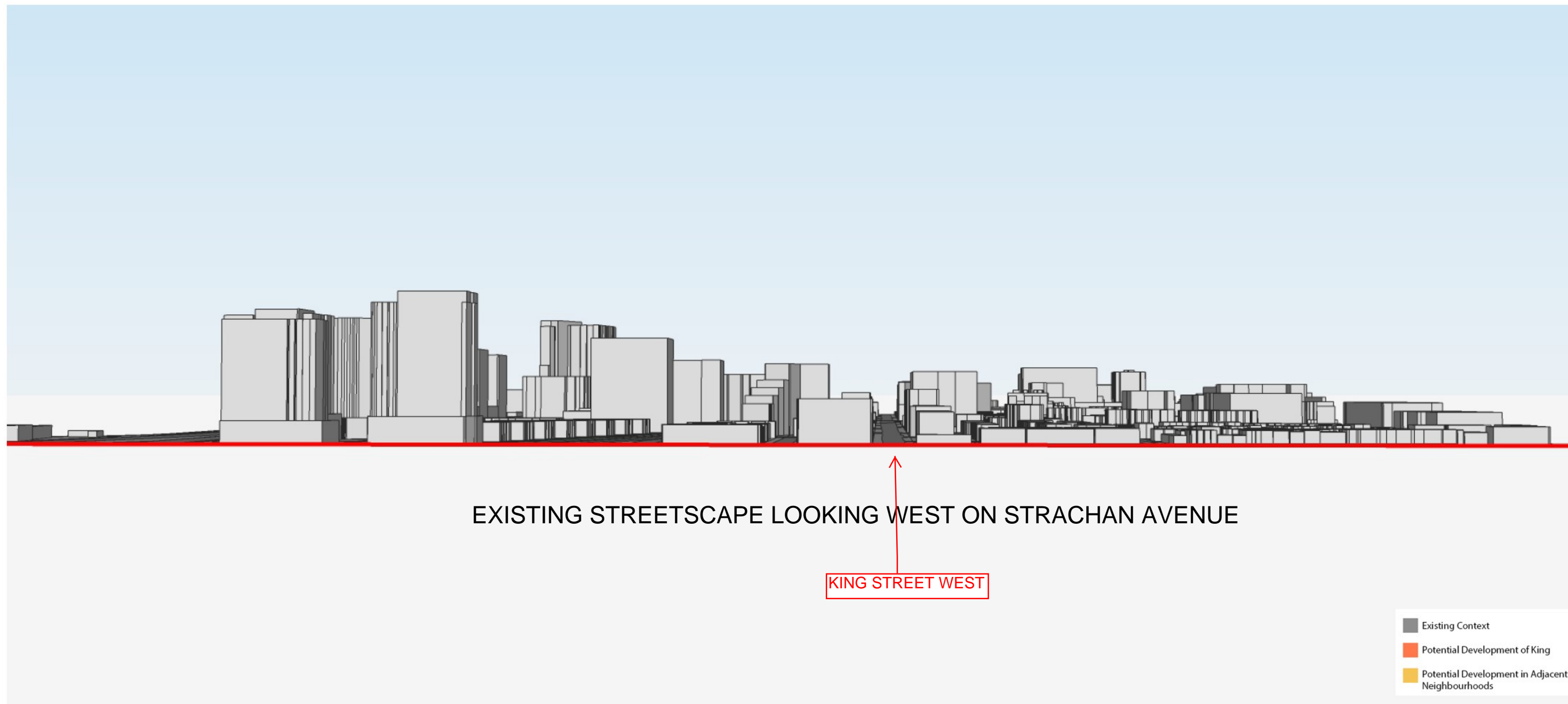

EXISTING STREETSCAPE LOOKING WEST ON STRACHAN AVENUE

KING STREET WEST

- Existing Context
- Potential Development of King
- Potential Development in Adjacent Neighbourhoods



STREETSCAPE LOOKING WEST ON STRACHAN AVENUE WITH POTENTIAL DEVELOPMENT ON KING STREET WEST

KING STREET WEST

- Existing Context
- Potential Development of King
- Potential Development in Adjacent Neighbourhoods

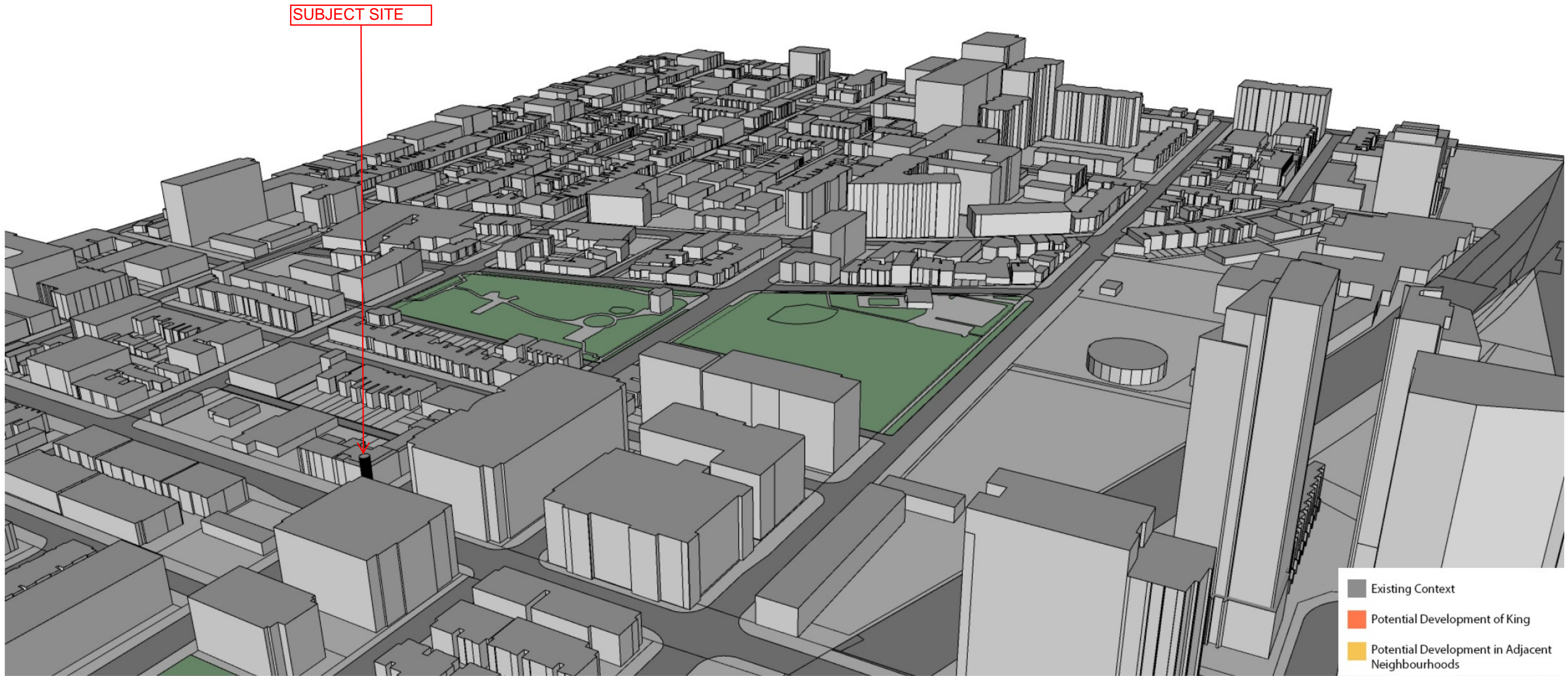

EXISTING MASSING LOOKING NORTHEAST

SUBJECT SITE

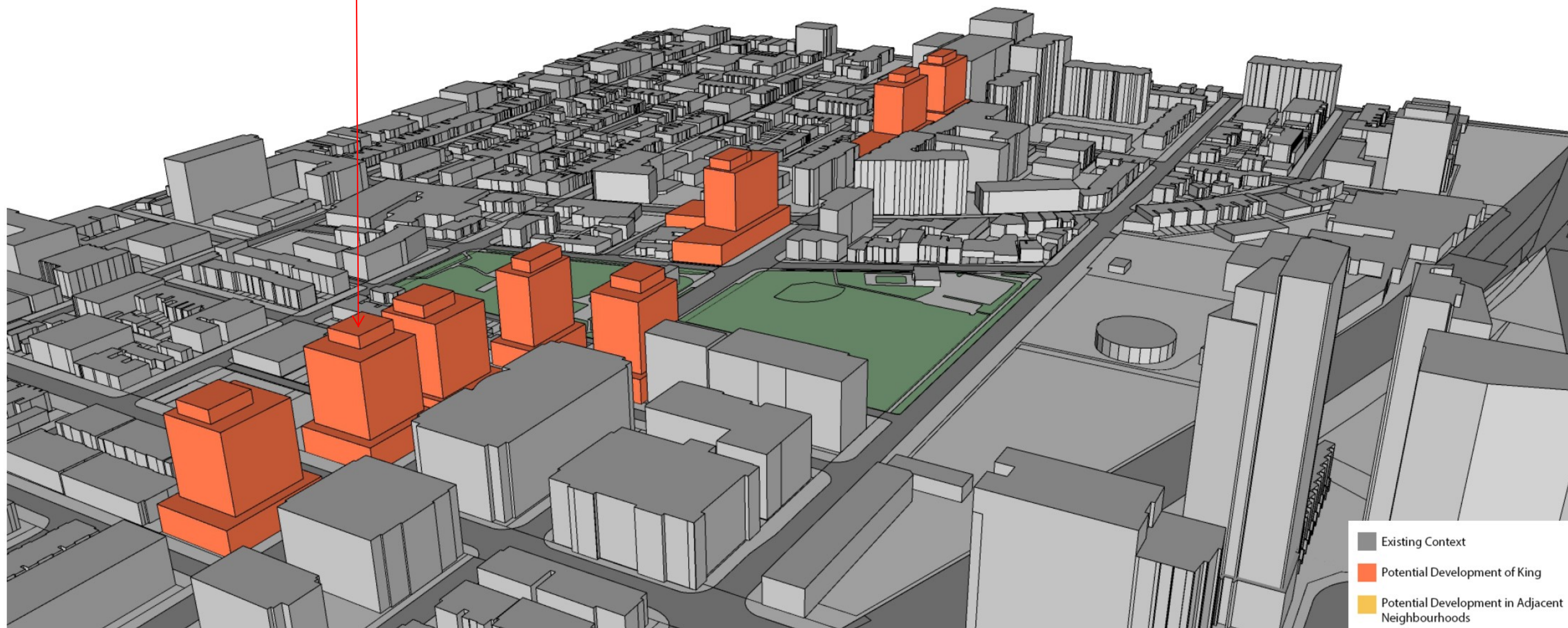

- Existing Context
- Potential Development of King
- Potential Development in Adjacent Neighbourhoods

MASSING LOOKING NORTHEAST WITH POTENTIAL DEVELOPMENT ON KING STREET WEST

SUBJECT SITE

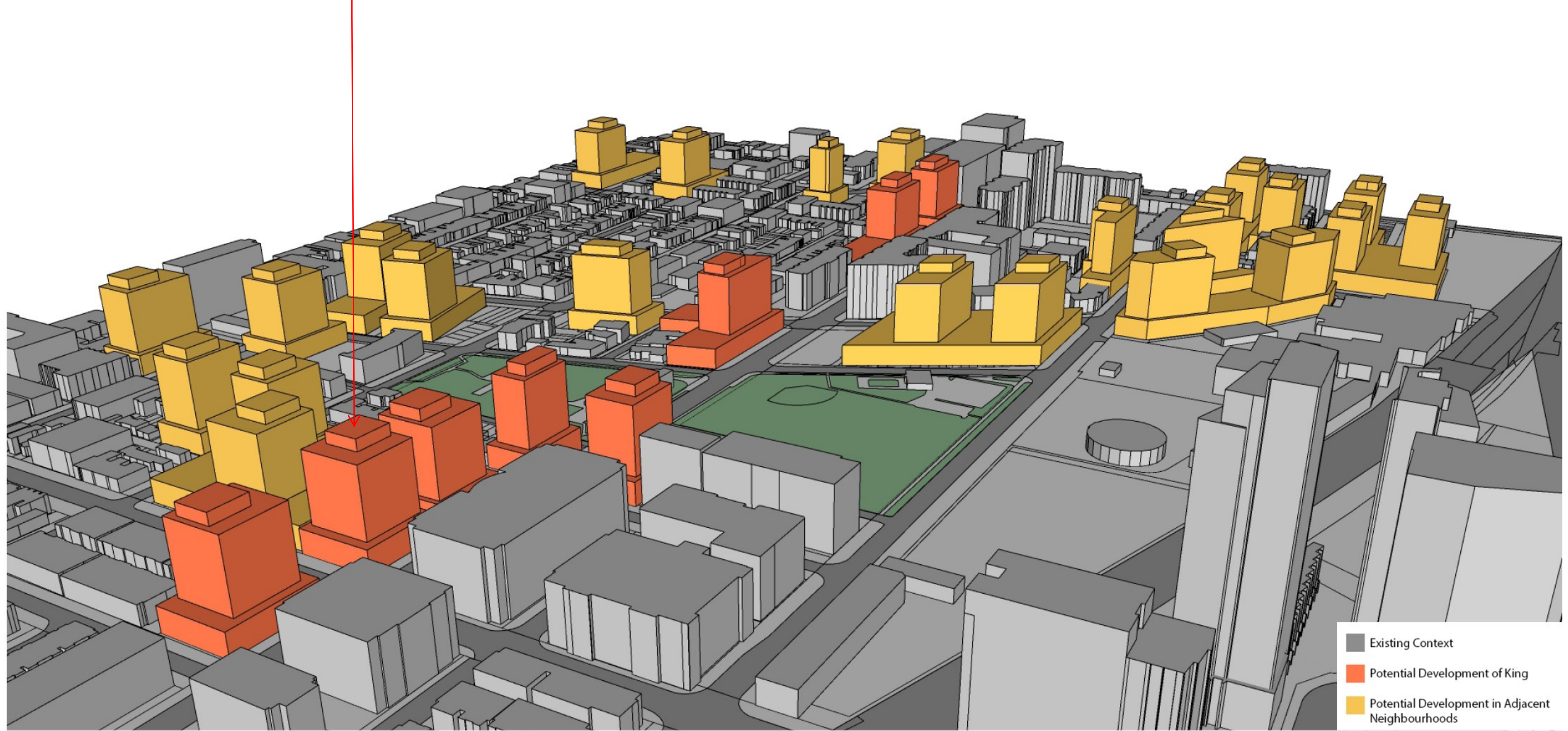

- Existing Context
- Potential Development of King
- Potential Development in Adjacent Neighbourhoods

MASSING LOOKING NORTHEAST WITH POTENTIAL DEVELOPMENT ON KING STREET WEST AND IN ADJACENT NEIGHBOURHOODS

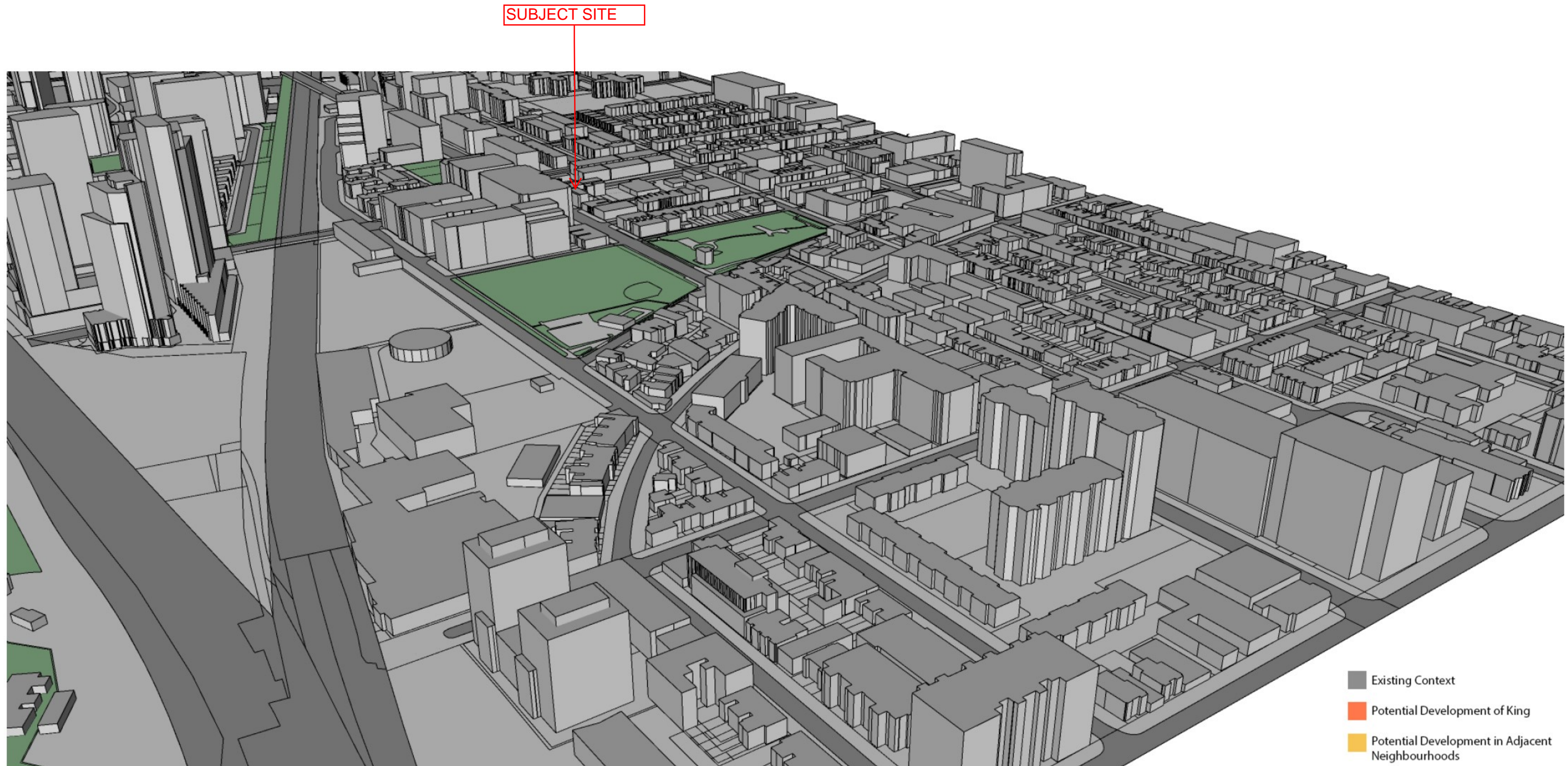

EXISTING MASSING LOOKING NORTHWEST

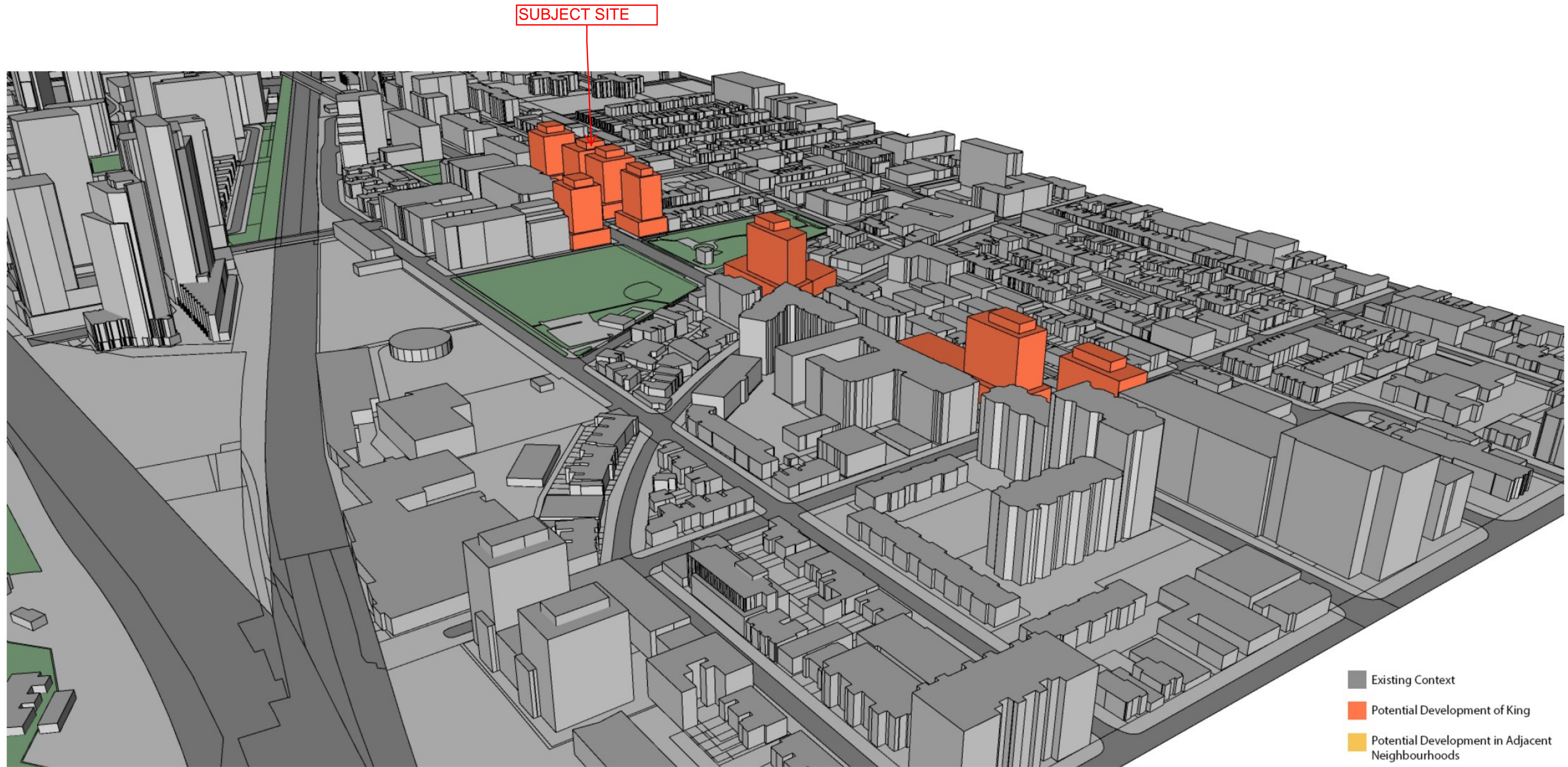

MASSING LOOKING NORTHWEST WITH POTENTIAL DEVELOPMENT ON KING STREET WEST

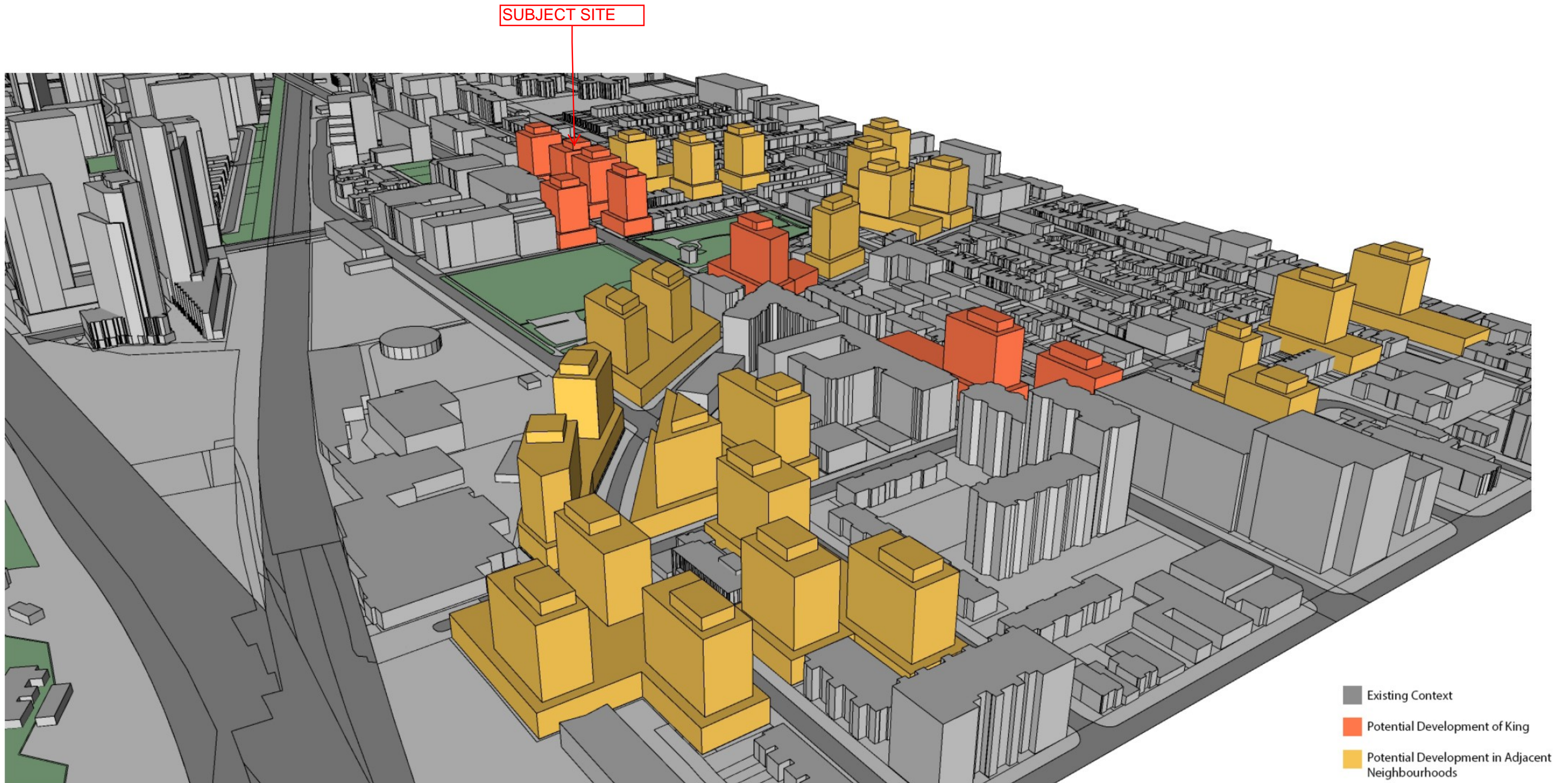

MASSING LOOKING NORTHWEST WITH POTENTIAL DEVELOPMENT ON KING STREET WEST AND IN ADJACENT NEIGHBOURHOODS

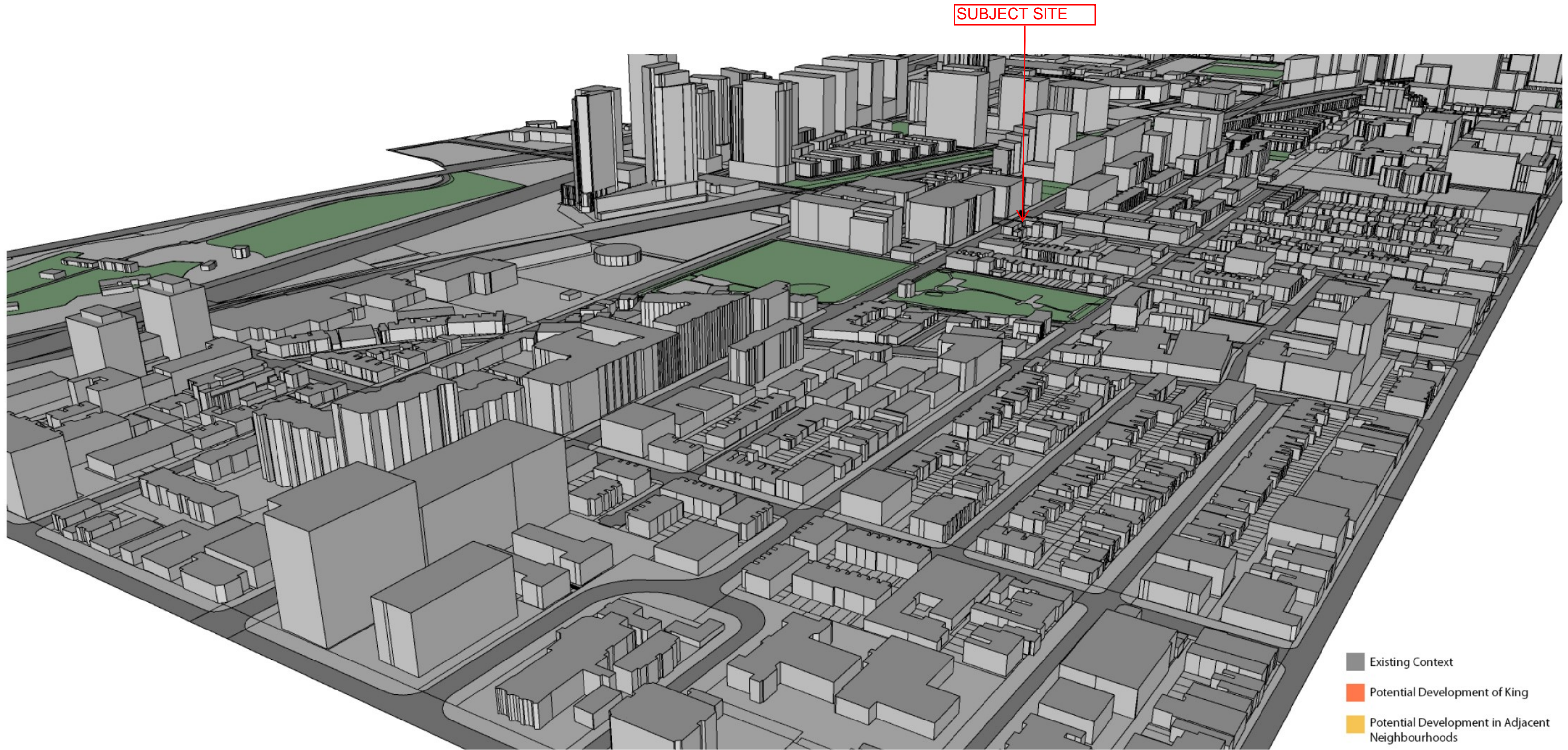

EXISTING MASSING LOOKING SOUTHWEST

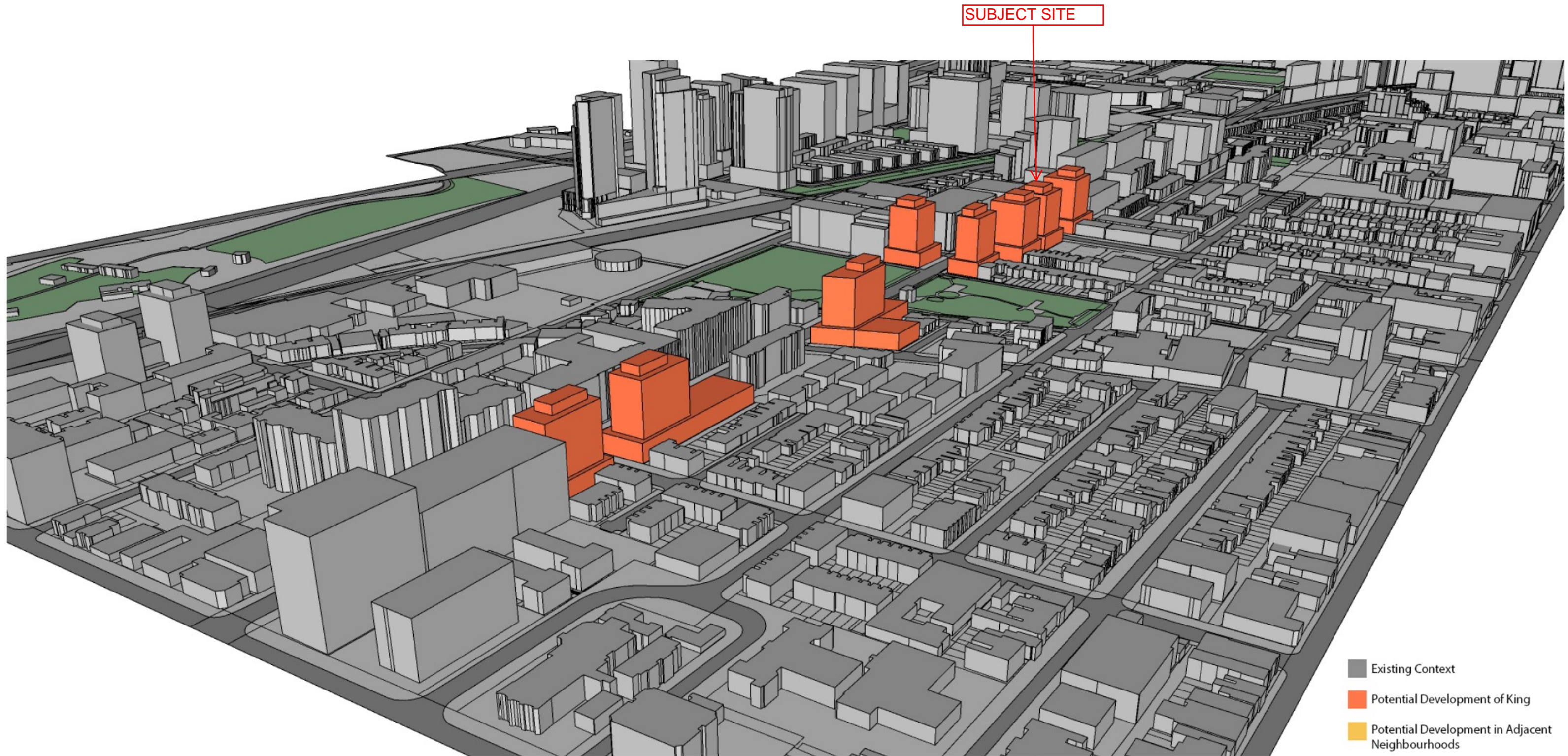

MASSING LOOKING SOUTHWEST WITH POTENTIAL DEVELOPMENT ON KING STREET WEST

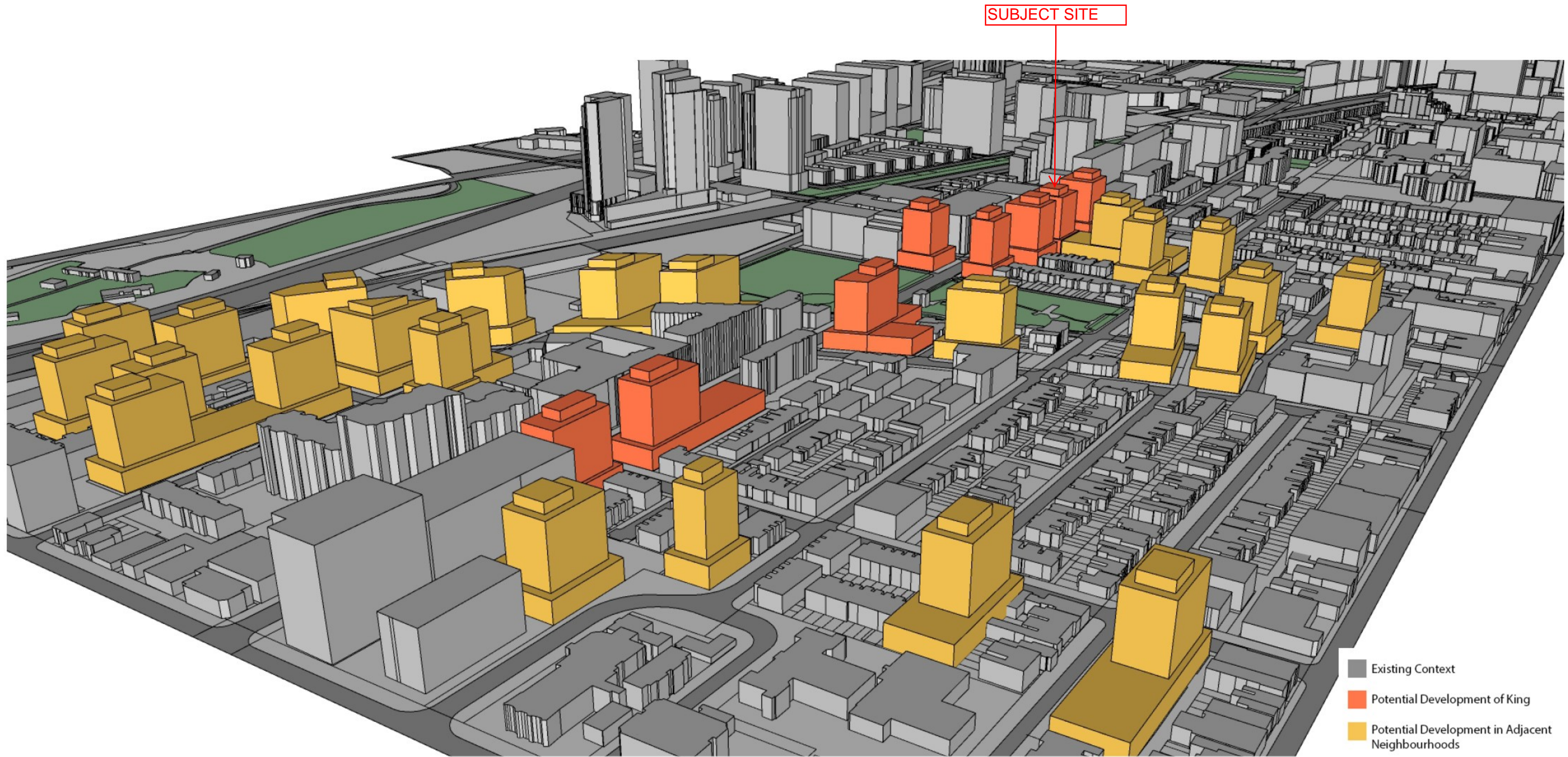

MASSING LOOKING SOUTHWEST WITH POTENTIAL DEVELOPMENT ON KING STREET WEST AND IN ADJACENT NEIGHBOURHOODS

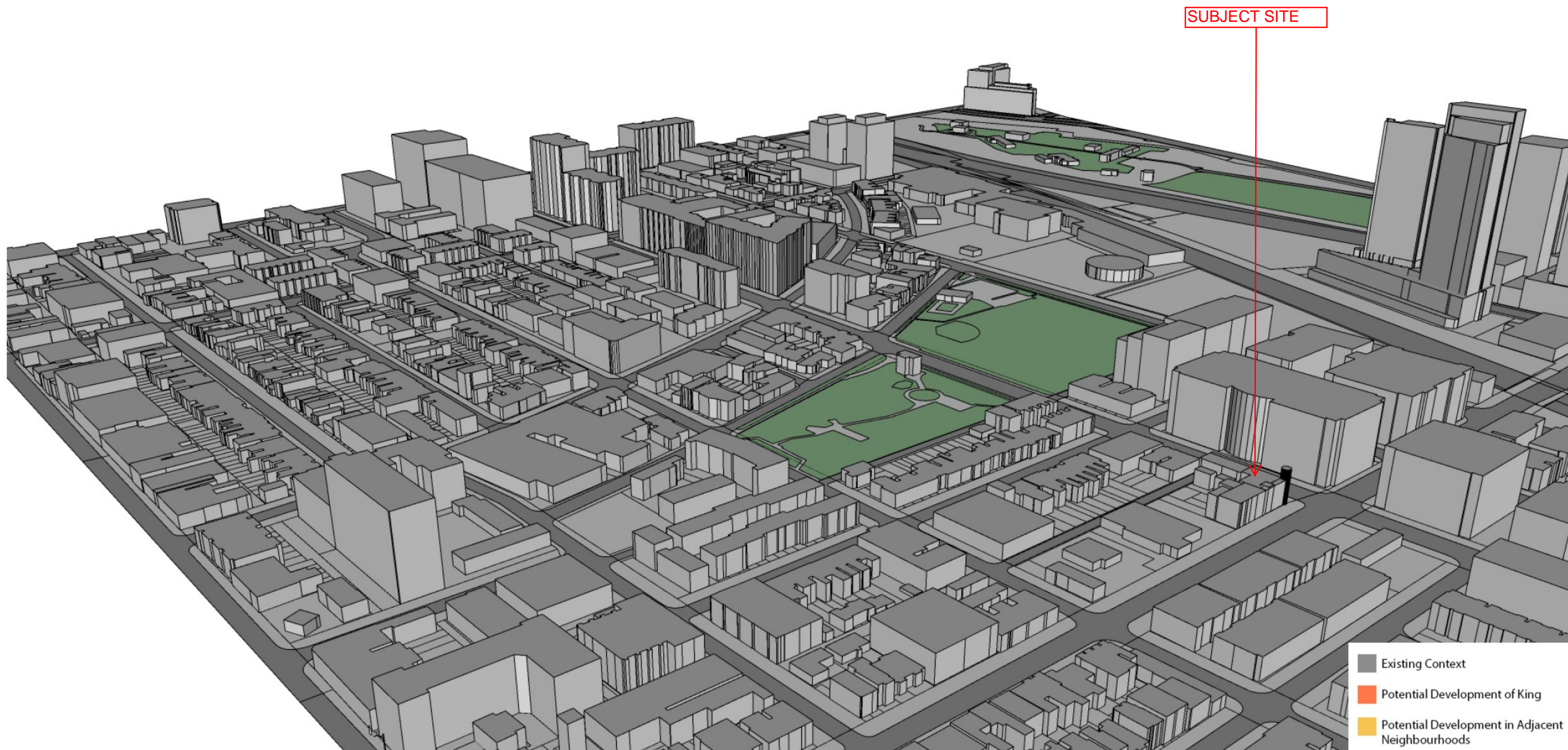

EXISTING MASSING LOOKING SOUTHEAST

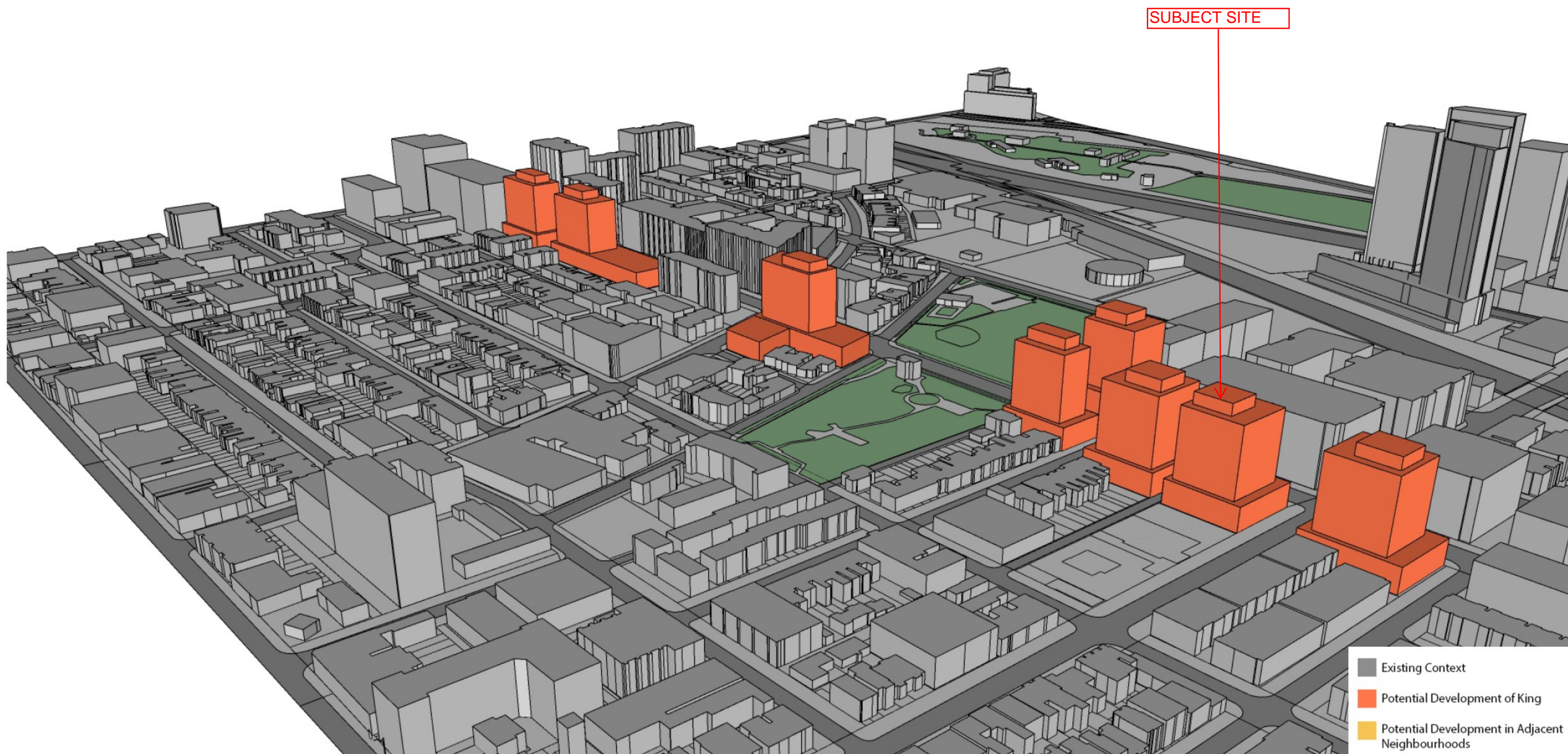

MASSING LOOKING SOUTHEAST WITH POTENTIAL DEVELOPMENT ON KING STREET WEST

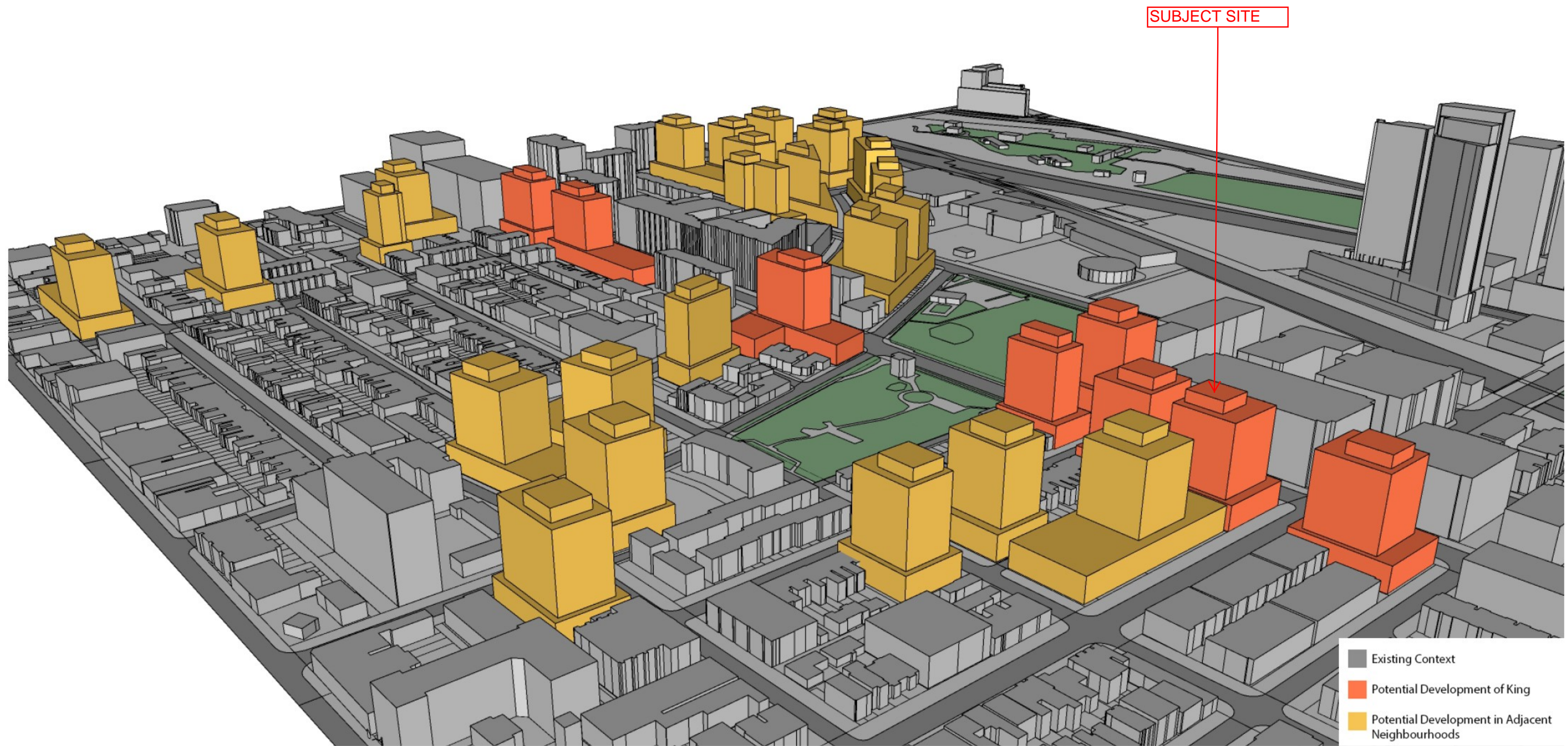

MASSING LOOKING SOUTHEAST WITH POTENTIAL DEVELOPMENT ON KING STREET WEST AND IN ADJACENT NEIGHBOURHOODS